

# **Wagga Wagga Hospital Multi Storey and On Grade Carparks**

## Landscape Schematic Design

October 2020







Extent of Carpark works



MSCP Carpark



Lewis Drive Tree planting to match existing Pyrus species



Grove of trees in Deco granite



Enviroslat bench seating to match stage 3



Forecourt paving to match stage 3 natural stone paving on colonnade to main pedestrian entry



Lawn with tree planting to southern boundary



# Docker Street Carpark



Tree and understory planting to islands



Existing Docker Street fence to be retained with boundary shrub and groundcover planting



Docker Street Trees to be retained



Yathong Street Carpark

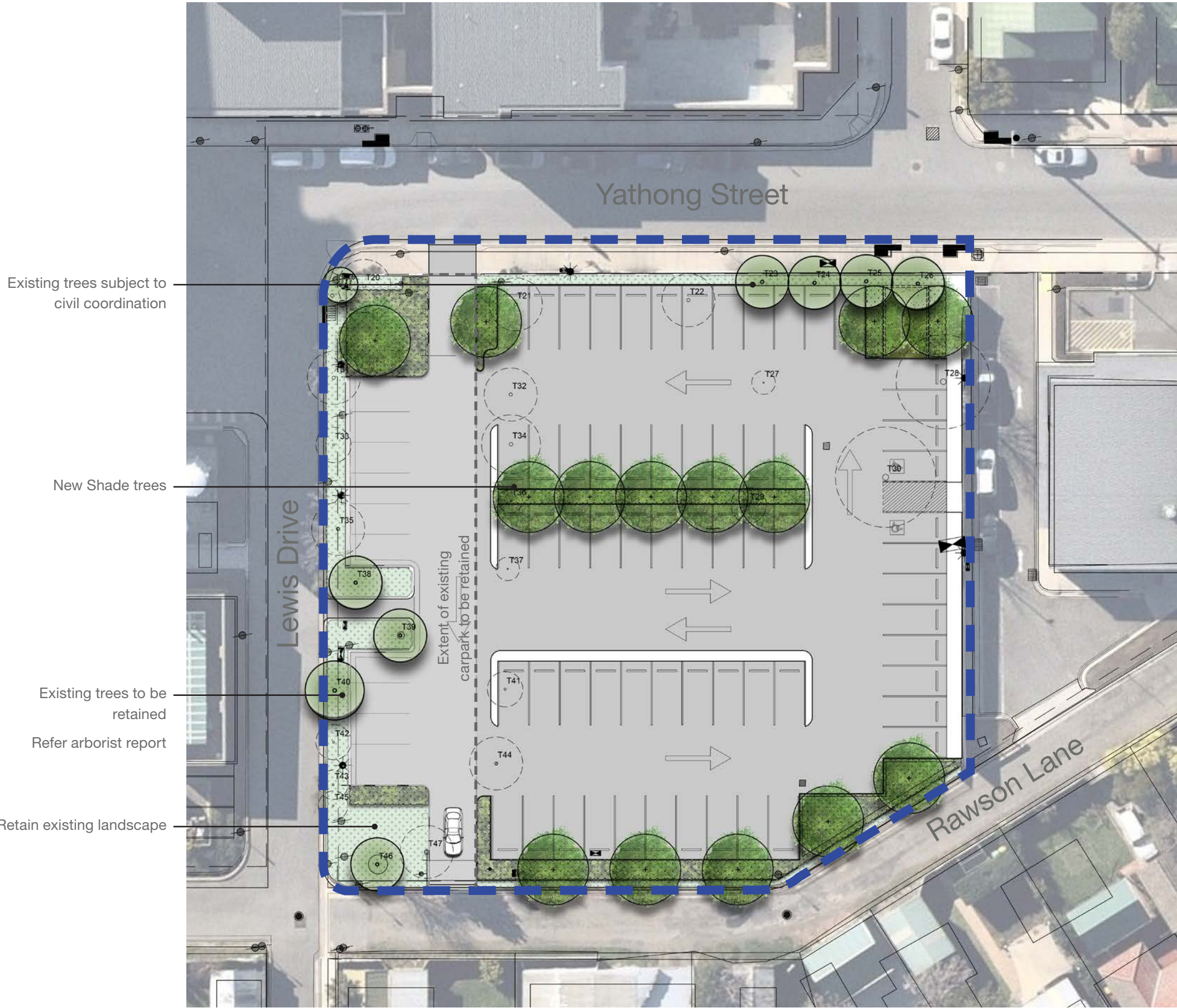

Lewis Drive Tree  
planting to match  
existing



Low grass and  
groundcover planting



Tree Planting to match  
northern carpark



# Planting

## Planting Palette

- Provide Shade trees to hard surfaces in carparks
- Retain existing trees as possible
- Resilient low water use species
- Mixture of native and exotic species
- Layered planting of shrubs, grasses, groundcovers
- Appropriate for hot dry summers and cool winters with frost
- Non toxic, low allergenic species
- Tie in to campus wide planting strategy with species used in Mental health, stages 2, 3
- Planting form and heights to ensure CPTED principles are upheld

## Trees



*Banksia integrifolia*  
Coast Banksia



*Brachychiton populneus*  
Kurrajong



*Gleditsia triacanthos 'Shademaster'*  
Honey Locust



*Pyrus calleryana 'Chanticleer'*  
Callery Pear



*Magnolia grandiflora 'Little Gem'*  
Magnolia Little Gem

## Shrubs / Accents / Groundcovers



*Anigozanthos 'Bush Gem'*  
Kangaroo Paw



*Carpobrotus glaucescens*  
Pigface



*Correa alba*  
White Correa



*Dietes iridoides*  
Wild Iris



*Gazania tomentosa*  
Gazania



*Hibbertia scandens*  
Golden Guinea Vine



*Rosmarinus officinalis 'Blue Lagoon'*  
Rosemary



*Juniperus horizontalis 'Douglasii'*  
Prostrate Juniper



*Lomandra longifolia 'Tanika'*  
Dwarf Mat Rush



*Myoporum parvifolium*  
Creeping Boobialla



*Trachelospermum jasminoides*  
Star Jasmine



Tree Removal Plan

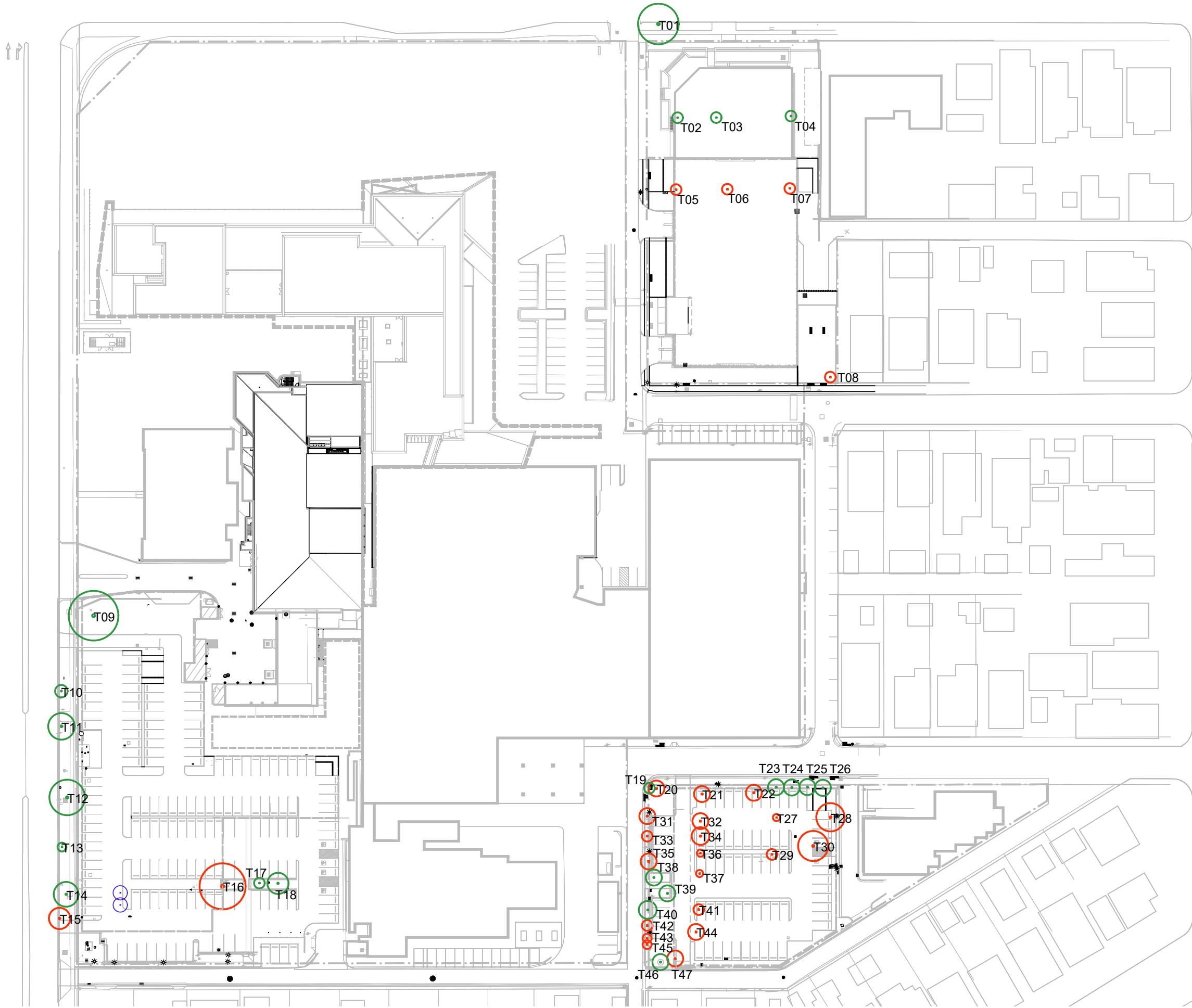

- Palm to be transplanted within Hospital Campus
- Existing Tree to be Retained
- Existing tree to be removed

Tree numbers refer to Mark D. McCrone  
Tree Survey, October 2020